

4A
760 SF

4B + Mezz
1,022 + 400 = 1,422 s.f.

4C + Mezz
1,022 + 400 = 1,422 s.f.

4D + Mezz
1,301 + 424 = 1,725 SF

4J + Mezz
474 SF + 170 SF
644 SF

4E + Mezz.
817 + 353
= 1,170 S.F.

4F
841 SF

4I + Mezz.
1,159 + 385 = 1,544 SF

4H + Mezz.
1,018 + 400 = 1,418 SF

4G + Mezz.
1,018 + 400 = 1,418 SF

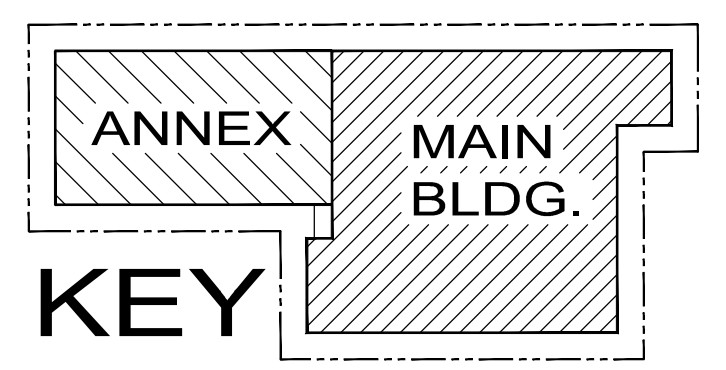

Fourth Floor Plan

Scale : 3/16" = 1'-0"

FOURTH FLOOR PLAN **A-4**

170 Lafayette Street		JERSEY CITY, N.J.		SHEET	OF
REVISION 4.22.14	JAMES S. McNEIGHT ARCHITECT PLANNER PC 169 SCHUYLER AVENUE KEARNY, NEW JERSEY 07032 (201) 246-7315 (FAX) 246-7513 N.J. LICENSE NO. 08626 jmcneight@jamesmcneight.com		PROJECT: CONVERSION OF EXISTING 4-STORY WAREHOUSE & ANNEX INTO 46 RESIDENTIAL UNITS	JOB NO. DATE DRAWN BY: 7.7.13 S.J.P.	